

Ball Valves Series

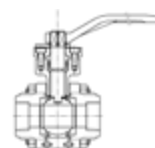
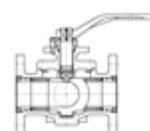
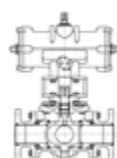
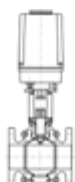
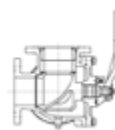
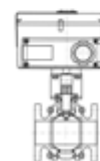
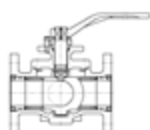
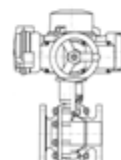
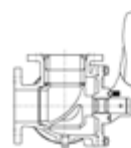
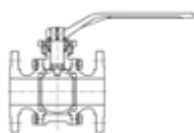
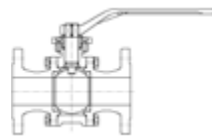
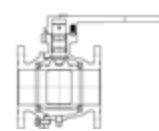
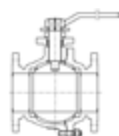

YONE valves are compact and lightweight

There are many valves all over the world, but there are reasons why many people choose our ball valves.

They are our strength and the result of our continued refinement of valve manufacturing technology.

We will contribute more to society through our valves.

With that in mind, we will continue to move forward step by step.

Why YONE's valves continue to be chosen by users:

- Compact, lightweight and easy to use.
- They are widely used where high quality is required, including specially equipped vehicles such as fire engines and tanker trucks, railways, ships, airports, steelmaking and electric power plants.
- Our valves have a track record of more than 50 years since we manufactured the first domestically produced ball valve in Japan.

Table of Contents

01	History of YONE Ball Valves
03	Features of YONE Products
04	YONE Original Ball Seat

Ball valves for specially equipped vehicles

06	Ball valves for fire trucks
07	Cast iron balls valve for tanker trucks
08	Stainless cast steel ball valve for tanker truck



	Ball valves for general industry		Automatic ball valves
10 ~ 11	Production range of ball valves	17	Air cylinder operated high frequency ball valves
12 ~ 14	2-way ball valves	18	Air cylinder operated ball valves
15	3-way ball valves	19	Electric motor operated ball valves
16	Screw-in type 2-way ball valves	20	Fire fighting equipment & couplings

History of YONE Ball Valves

The history of ball valves is said to have actually started when a patent application was filed in the United States in 1888.

In Japan, the Osaka City Fire Department purchased a fire truck from the United States in 1954, and we quickly improved and manufactured ball valves, referring to the ball valves that came with the fire engine. This ball valve was the first made in Japan.

Since then, through repeated research and development, YONE ball valves have been widely used for transportation such as tanker trucks, railroads and ships as well as in general industrial applications such as petrochemical plants, steelworks, power plants and water treatment industries.



1941

Founded Yoneda Seisakusho K.K. (current YONE Corporation). Then opened a copper alloy casting factory and started manufacturing aircraft and other parts.



Photo credit: Osaka City Fire Department

1955

Developed the first domestically produced ball valve and installed it for fire engines



Delivery Record

Fire trucks



Fire extinguishing equipment



Tanker trucks



Railways



Ships



Airports



Steelworks



Power plants



Features of YONE Products

Ball valves for specially equipped vehicles
Compact design model for vehicles

Ball valves for Fire trucks



Ball valves for tanker trucks



1. Lightweight and compact design

When installing a valve in piping, you may be forced to install it in a narrow and intricate plumbing line. Also, when installing valves in vehicles, it is necessary to make the piping equipment as light and small as possible. YONE's ball valve is especially useful when installing it in vehicles and when it is necessary to reduce the weight and increase the compactness of the entire device.

Comparison between our general-purpose JIS ball valve and ball valve for tanker trucks

Nominal diameter 65A

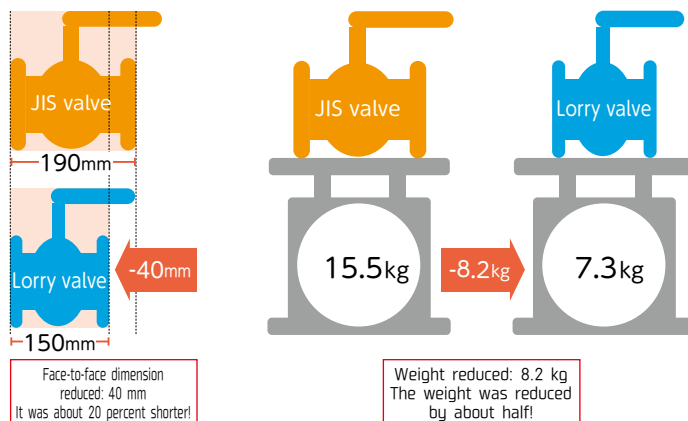

Comparison table (lorry valve/JIS valve)		
Nominal diameter	Weight kg	Face-to-face dimension mm
	Lorry valve/JIS valve	Lorry valve/JIS valve
50	5.6/10.5	130/178
65	7.3/15.5	150/190
80	9.8/19.5	170/203

2. Adoption of original ball seat

Equipped with MR seat as standard (see next page)

※In addition, equipped with a drain plug as standard.

Ball valves for industry
General-purpose standard ball valve

Our ball valves flexibly support ASME and JPI standards as well as JIS standards. We have delivered many ball valves for ships, airports and electric power facilities. We also have many new developments to meet user needs.



YONE Original Ball Seat MR-Seat

MR seat (metal-rubber seat) is an epoch-making soft seat originally developed by YONE.

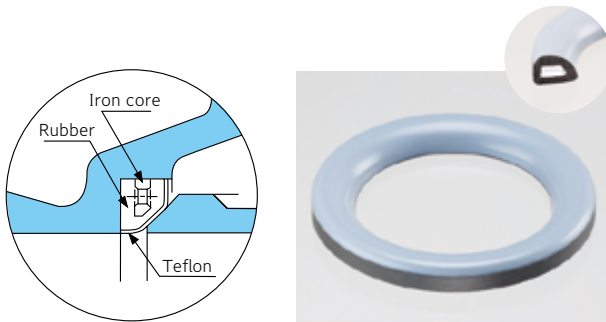

Features

PTFE that is mainly used as a sealing material for valves has excellent chemical and heat resistance.

On the other hand, due to the scratchable nature of PTFE itself, the fluid range is limited to some extent. To solve this problem, we have developed a ball seat in which Teflon is crimped to rubber containing an iron core. By adopting this seat, the elasticity of rubber and the low friction of Teflon are combined to realize a ball valve that is leak resistant and has good operability.

Comparison of operating torque Comparison of PTFE seat and MR seat (compared to our conventional product)

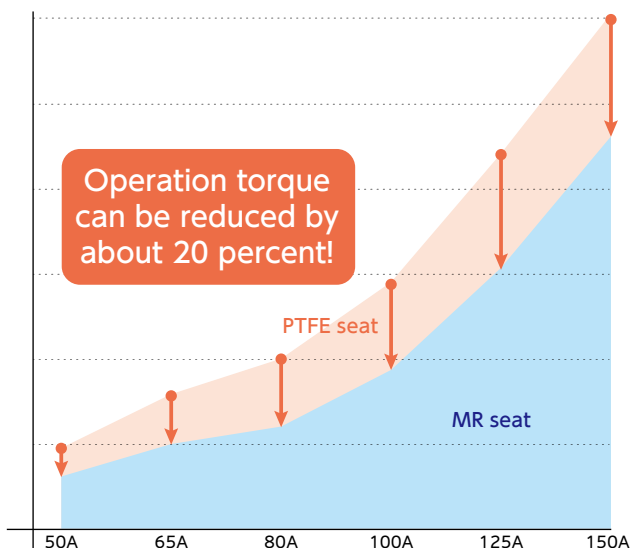

Various ball seats

Types and features of ball seats

MR seat (symbol: MR)

Temperature range: -10 to 80° C

This seat uses YONE's original sealing method. The main component is synthetic rubber; an iron core is incorporated inside as a core material. Teflon is crimped to the rubber surface where the ball slides, maintaining high sealing performance and achieving low torque.



PTFE (symbol: W1)

Temperature range: -20 to 140° C

This seat can function at relatively low temperatures and pressures while still providing excellent chemical resistance and low friction characteristics.



Glass fiber + PTFE containing MoS2 (symbol: H3)

Temperature range: -10 to 140° C

This material is reinforced PTFE made by mixing glass fiber and MoS2 with PTFE, which improves the compression creep resistance and wear resistance that are the weak points of pure PTFE, and is suitable for use under high-pressure conditions.



PTFE with carbon fiber (symbol: R4)

Temperature range: 0 to 200° C

This material is reinforced PTFE, which is a mixture of PTFE and carbon fiber, and improves creep resistance and wear resistance at high temperatures. It is also suitable for use in fluids containing slurries.



- * 1. The above temperature range varies depending on the pressure conditions and the fluid used.
For detailed specification conditions, contact us.
- * 2. We also handle carbon and metal seats. Contact us for details.

Ball Valve for Specially Equipped Vehicles

Water and fuels such as gasoline and light oil are indispensable for our lives. Numerous specially equipped vehicles that carry these liquids are used every day and support our lives.

YONE started manufacturing valves for specially equipped vehicles in 1955. Since then, we have worked hard to satisfy our customers and many specially equipped vehicle manufacturers now use our valves.



Features of ball valves for specially equipped vehicles

- The valves are lighter and more compact than conventional JIS standard ball valves.
- The dimensions of each part of the flange conform to firefighting, tanker truck and similar standards.
- Equipped with a drain plug as standard.
- The valves are more compact for installing them in the vehicles and for the entire device.

Ball valves for fire trucks



YONE's ball valves for fire engines are installed in more than 90 percent of fire engines in Japan as standard ball valves due to their high reliability.

A discharge (single seal) type that controls one-way flow and a suction (double seal) type that controls both flows are provided.

Discharge type

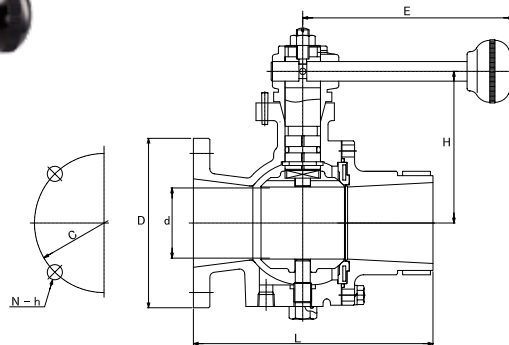

Material list	
Part name	Standard material
Body	FC200
Fitting	A6061FD
Ball	CAC406
Stem	C3604 BD
Ball seat	MR-NBR

Suction type

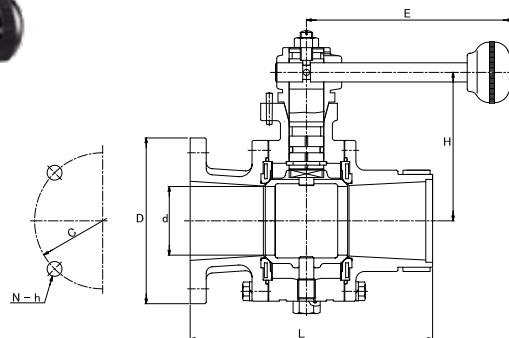

Material list	
Part name	Standard material
Body	FC200
Flange	A6061FD
Ball	CAC406
Stem	C3604 BD
Ball seat	MR-NBR

Size	Discharge type	Suction type			
	65A	65A	75A	90A	100A
d: Port diameter	57	55.5	76	89	102
L: Face-to-face dimension	190	195	237	261	270
H: Height	120	120	138	158	165
E: Lever dimension	167	167	185	226	226

Japanese fire flange size	Suction type			
	65A	75A	90A	100A
D: Outside diameter	134	150	180	180
C: Pitch Circle Diameter	110	125	150	150
N-h: Number of holes - Hole diameter	4-φ12	6-φ12	6-φ13	6-φ13

Ball valves for tanker trucks

YONE has been manufacturing ball valves according to numerous standards for tanker trucks and sprinklers for over 50 years and has the top share in Japan.

The two-, three- and four-way valves have different roles as shown on the left for general use in tank lorry piping.

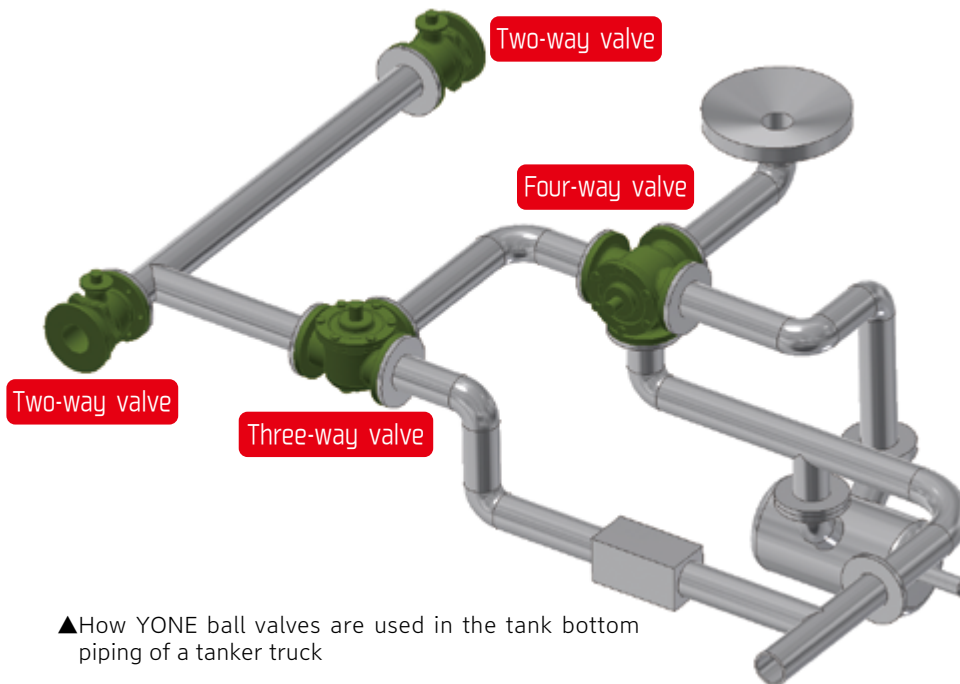

▲How YONE ball valves are used in the tank bottom piping of a tanker truck

TYPE:RE Cast iron ball valve (main body material: FC200, size: 50A to 80A)

Two-way

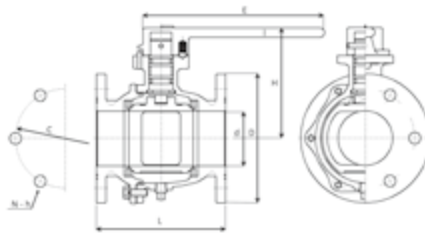

Part name	Standard material
Body	FC200
Flange	FC200
Ball	FC200 H.Cr plating
Stem	C3604BD
Ball seat	MR-NBR

Size	50A	65A	80A
d: Diameter	50	63.5	76
L: Face-to-face dimension	130	150	170
H: Height	118	128.5	135.5
E: Lever dimension	190	190	190

Size	50A	65A	80A
D: Outside diameter	130	150	165
C: Pitch Circle Diameter	105	115	130
N-h: Number of holes - Hole diameter	4/13.5	6/13.5	6/13.5
Weight (Kg)	5.6	7.3	9.8

Three-way

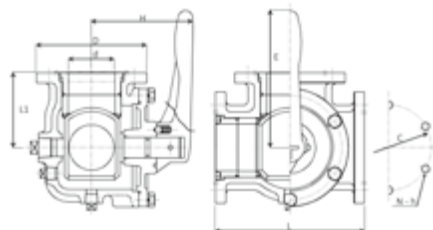

Part name	Standard material
Body	FC200
Hood	FC200
Ball	50A FC200 H.Cr plating 65A/80A CAC406 H.Cr plating
Ball seat	50A MR-NBR 65A/80A MR-NBR/MR-VITON

Size	50A	65A	80A
d: Diameter	50	63.5	76
L: Face-to-face dimension	180	200	220
L1: Center-to-face dimension	90	100	110
H: Height	125	143	161
E: Lever dimension	185	185	205

Size	50A	65A	80A
D: Outside diameter	130	150	160
C: Pitch Circle Diameter	105	115	130
N-h: Number of holes - Hole diameter	4/M12 P=1.25	6/M12 P=1.25	6/M12 P=1.75
Weight (Kg)	11.5	17	19

Four-way

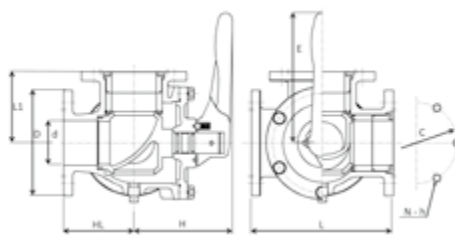
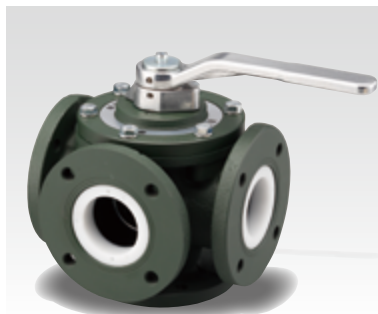

Part name	Standard material
Body	FC200
Flange	FC200
Ball	FC200 H.Cr plating
Ball seat	50A MR-NBR
	65A/80A MR-NBR/MR-VITON

Size	50A	65A	80A
d: Diameter	50	63.5	76
L: Face-to-face dimension	180	200	220
L1: Center-to-face dimension	90	100	110
H: Height	80	100	110
H: Height	125	150	161
E: Lever dimension	185	185	205

Size	50A	65A	80A
D: Outside diameter	130	150	165
C: Pitch Circle Diameter	105	115	130
N-h: Number of holes - Hole diameter	4/M12 P=1.25	6/M12 P=1.25	6/M12 P=1.75
Weight (Kg)	11.5	16.5	22

TYPE:SL Stainless cast steel ball valve (main body material: SCS13A, size: 50A to 80A)

Two-way

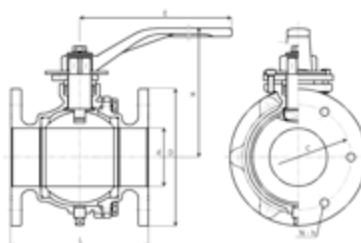

Part name	Standard material
Body	SCS13A
Flange	SCS13A
Ball	SUS304
Stem	SUS304
Ball seat	PTFE

Size	50A	65A	80A
d: Diameter	50	63.5	76
L: Face-to-face dimension	130	150	170
H: Height	116	141	151
E: Lever dimension	180	260	260

Size	50A	65A	80A
D: Outside diameter	130	150	165
C: Pitch Circle Diameter	105	115	130
N-h: Number of holes - Hole diameter	4/13.5	6/13.5	6/13.5
Weight (Kg)	5.8	8.8	11.5

Three-way

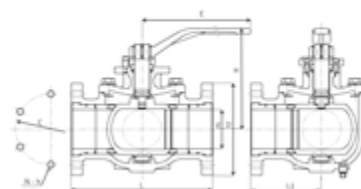

Part name	Standard material
Body	SCS13A
Hood	SCS13A
Ball	[50A/65A] SUS304
	[80A] SCS13A
Stem	SUS304
Ball seat	PTFE

Size	50A	65A	80A
d: Diameter	50	63.5	76
L: Face-to-face dimension	200	230	240
L1: Center-to-face dimension	100	115	120
H: Height	160	165	185
E: Lever dimension	260	260	260

Size	50A	65A	80A
D: Outside diameter	130	150	165
C: Pitch Circle Diameter	105	115	130
N-h: Number of holes - Hole diameter	4/M12 P=1.75	6/M12 P=1.75	6/M12 P=1.75
Weight (Kg)	14	19	24

Four-way

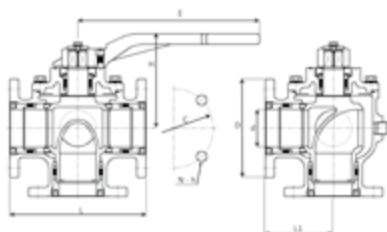

Part name	Standard material
Body	SCS13A
Hood	SCS13A
Ball	SCS13A
Ball seat	PTFE

Size	50A	65A	80A
d: Diameter	50	63	76
L: Face-to-face dimension	180	200	220
L1: Center-to-face dimension	90	100	110
H: Height	125	130	140
E: Lever dimension	240	240	300

Size	50A	65A	80A
D: Outside diameter	130	150	165
C: Pitch Circle Diameter	105	115	130
N-h: Number of holes - Hole diameter	4/13.5	6/M12 P=1.75	6/M12 P=1.75
Weight (Kg)	11.8	15.6	20.3

Ball Valve for General Industry

YONE started manufacturing the first domestic ball valves in Japan in 1955. Since then, we have continued our research and development to create better valves that are easier for people to use. Creating products that meet the needs of each and every customer, YONE provides products that are deeply rooted in today's social infrastructure, both in Japan and overseas.



Features of ball valves for industry

- **Three-piece body**

The standard body of the YONE ball valve is three pieces with the valve body sandwiched between two flanges. The connection method can correspond to patterns such as flanges, screws and hose couplings.

- **MR seat (MR) and PTFE seat (W1) meet a wide range of needs**

Both seats are compatible. In particular, MR seats are highly evaluated because a unique sealing method is used.

- **Star-shaped lever**

YONE's stem uses a quadrangle as standard. It can be opened and closed at a 45° pitch using a star-shaped handle.

- **80A (3B) and above valves have a trunnion structure**

For the valves of 80A and above, the trunnion type is standardized. Since the valve body ball is fixed by the valve shaft and the fixed shaft, the opening and closing operation can be reduced in weight even when additional pressure is applied.

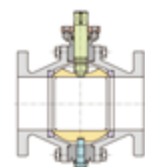

MR seat



PTFE seat



Trunnion structure



Floating structure

Manufacturing range of the two-way ball valve

Standard manufacturing item	two-way ball valve													
Connection method	two-way flange or two-way screw													
Material	FCD				SCPH2				SCS13A/SCS14A					
Connection standard	JIS5K	JIS10K 150Lb	JIS20K	Rc screw	JIS5K	JIS10K 150Lb	JIS20K 300Lb	JIS40K 600Lb	JIS5K	JIS10K 150Lb	JIS20K 300Lb	JIS40K 600Lb	Rc screw	
15A(1/2B)	○	○	○	○	*	*	*	○	○	○	○	○	○	
20A(3/4B)	○	○	○	○	*	*	*	○	○	○	○	○	○	
25A(1B)	○	○	○	○	○	○	○	○	○	○	○	○	○	
32A(1.1/4B)	○	○	○	○	○	○	○	○	○	○	○	○	○	
40A(1.1/2B)	○	○	○	○	○	○	○	○	○	○	○	○	○	
50A(2B)	○	○	○	○	○	○	○	○	○	○	○	○	○	
65A(2.1/2B)	○	○	○		○	○	○	○	○	○	○	○		
80A(3B)	○	○	○		○	○	○	○	○	○	○	○		
100A(4B)	○	○	○		○	○	○	○	○	○	○	○		
125A(5B)	◎	◎	◎		○	○	○	○	○	◎	◎	○		
150A(6B)	◎	◎	◎		○	○	○	○	○	◎	◎	○		
200A(8B)	◎	◎	◎		○	○	*	*	○	◎	◎			
250A(10B)	◎	◎	◎		○	○	*	*	○	◎	◎			
300A(12B)	◎	◎	◎		○	○	*	*	○	◎	◎			
350A(14B)	◎	◎	◎		○	○	*	*	○	◎	◎			
400A(16B)	◎	◎	*		*	*	*	*	*	*	*	*		*
450A(18B)	◎	◎	*		*	*	*	*	*	*	*	*		*
500A(20B)	*	*	*		*	*	*	*	*	*	*	*		*

○………… Full-bore

◎………… Full-bore and reduced bore

(450×400A/400A×350A/350A×300A/300A×250A/250A×200A/200A×150A / 150A×125A / 125A×100A)

*………… For this product, please contact us.

Other …… 80A, 100A, 125A and 150A products have a cam lock (aluminum) connection.

TYPE:BV Ball Valve for General Industry

Manufacturing range of the three-way ball valve

Standard manufacturing item	three-way ball valve						
Connection method	three-way flange						
Material	FCD			SCS13A/SCS14A			
Connection standard	JIS5K	JIS10K 150Lb	JIS20K 300Lb	JIS5K	JIS10K 150Lb	JIS20K 300Lb	JIS40K 600Lb
25A(1B)	○	○	*	○	○	*	*
32A(1.1/4B)	○	○	*	○	○	*	*
40A(1.1/2B)	○	○	*	○	○	*	*
50A(2B)	○	○	*	○	○	*	*
65A(2.1/2B)	○	○(150Lb:*)	*	○	○(150Lb:*)	*	*
80A(3B)	○	○(150Lb:*)	*	○	○(150Lb:*)	*	*
100A(4B)	○	○(150Lb:*)	*	○	○(150Lb:*)	*	*
125A(5B)	○	○	*	○	○	*	*
150A(6B)	○	○	*	○	○	*	*
200A(8B)	○	○	*	*	*	*	*
250A(10B)	○	○	*	*	*	*	*
300A(12B)	○	○	*	*	*	*	*

○…………Full-bore

*…………For this product, please contact us.

TYPE:YHW Ball Valve for General Industry

Manufacturing range of the high frequency ball valve

Standard manufacturing item	two- or three-way high frequency automatic ball valve			
Connection method	two-way flange		three-way flange	
Material	FCD			
Connection standard	JIS10K 150Lb	JIS20K 300Lb	JIS10K 150Lb	JIS20K 300Lb
40A(1.1/2B)	○	○	○	○
50A(2B)	○	○	○	○
65A(2.1/2B)	○	○	○	○
80A(3B)	○	○	○	○
100A(4B)	○	○	○	○
125A(5B)	○	○	○	○
150A(6B)	○	○	○	○
200A(8B)	*	*	*	*
250A(10B)	*	*	*	*
300A(12B)	*	*	*	*

○…………Full-bore

*…………For this product, please contact us.

TYPE:BV Ball Valve for General Industry

two-way ball valve

Made of ductile cast iron (main body material: FCD-S)

10K/150Lb

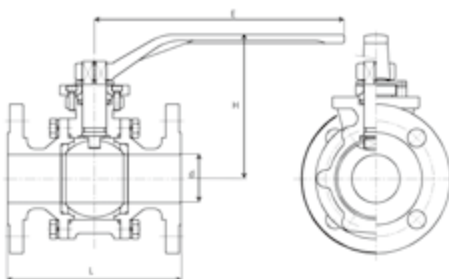

Part name	Standard material
Body	FCD-S ※200A~:FCD450
Flange	FCD-S ※200A~:FCD450
Ball	SUS304/SCS13A
Stem	SUS304
Ball seat	MR-NBR/PTFE

*For the ball seats, check the details.

Size	15A	20A	25A	32A	40A	50A	65A	80A	100A	125A	150A	200A	250A
d: Diameter	15	19	25	32	38	50	63.5	76	102	127	152	203	254
L: Face-to-face dimension	110	120	130	150	165	180	190	200	230	300	340	400	470
H: Height	90	104	114	119	124	150	160	178	220	245	265	These products are operated by worm gears. Contact us separately.	
E: Lever dimension	140	180	180	180	180	260	260	260	350	450	450		

*For other size, contact us separately.

20K

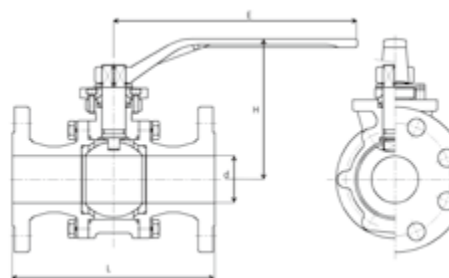

Part name	Standard material
Body	FCD-S ※200A~:FCD450
Flange	FCD-S ※200A~:FCD450
Ball	SUS304/SCS13A
Stem	SUS304
Ball seat	R.PTFE

*For the ball seats, check the details.

Size	15A	20A	25A	32A	40A	50A	65A	80A	100A	125A	150A	200A	250A
d: Diameter	15	19	25	32	38	50	63.5	76	102	127	152	203	254
L: Face-to-face dimension	110	120	130	150	190	216	241	283	305	381	403	502	568
H: Height	90	104	114	119	124	150	160	178	220	245	265	These products are operated by worm gears. Contact us separately.	
E: Lever dimension	140	180	180	180	180	260	260	260	350	450	450		

*For other size, contact us separately.

10K x cam lock (AC)

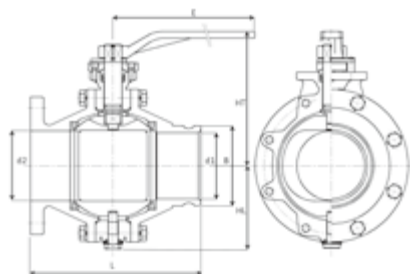

Part name	Standard material
Body	FCD
Flange	FCD
Cam lock	AC4C-T6
Ball	SUS304/SCS13A
Stem	SUS304
Ball seat	MR-NBR

*For the ball seats, check the details.

Size	80A	100A	125A	150A
d1: Cam lock diameter	71	97	120	150
d2: Flange diameter	76	102	127	152
B: Cam lock outer diameter	91.4	119.5	145.5	176
L: Face-to-face dimension	211	245	310	333
HT: Height	178	220	245	265
HL: Height	96	121	152	170
E: Lever dimension	260	350	450	450

two-way ball valve

Made of cast stainless steel (main body material: SCS13A/SCS14A)

10K/150Lb

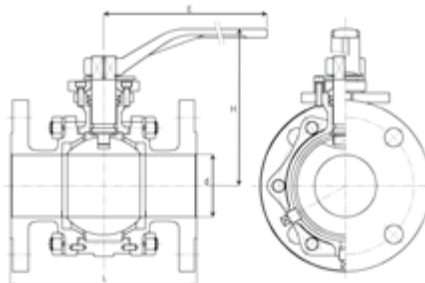

Part name	Standard material	
Body	SCS13A	SCS14A
Flange	SCS13A	SCS14A
Ball	SUS304/ SCS13A	SUS316/ SCS14A
Stem	SUS304	SUS316
Ball seat	MR-NBR/ PTFE	MR-NBR/ PTFE

*For the ball seats, check the details.

Size	15A	20A	25A	32A	40A	50A	65A	80A	100A	125A	150A	200A	250A
d: Diameter	15	19	25	38	38	50	63.5	76	102	127	152	203	254
L: Face-to-face dimension	110	120	130	165	165	180	190	200	230	300	340	400	470
H: Height	90	105	115	124	124	150	160	178	220	245	265	These products are operated by worm gears. Contact us separately.	
E: Lever dimension	140	180	180	180	180	260	260	260	350	450	450		

*For other diameters, contact us separately.

20K/300Lb

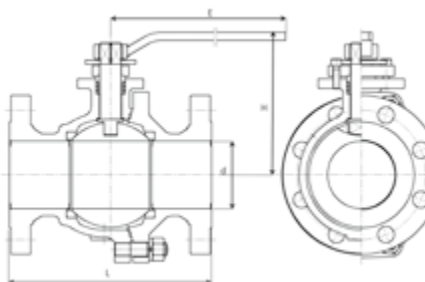

Part name	Standard material	
Body	SCS13A	SCS14A
Flange	SCS13A	SCS14A
Ball	SUS304/ SCS13A	SUS316/ SCS14A
Stem	SUS304	SUS316
Ball seat	R.PTFE	R.PTFE

*For the ball seats, check the details.

Size	15A	20A	25A	32A	40A	50A	65A	80A	100A	125A	150A	200A	250A
d: Diameter	15	19	25	32	38	50	63.5	76	102	127	152	203	254
L: Face-to-face dimension	140	152	165	178	190	216	241	283	305	381	403	502	568
H: Height	89	99	109	114	119	137	165	188	213	251	287	These products are operated by worm gears. Contact us separately.	
E: Lever dimension	140	140	180	180	180	260	450	450	600	600	800		

*For other diameters, contact us separately.

YONE COLUMN

Valve body materials handled by YONE

- FCD-S (Ductile cast iron): Used as standard with YONE two-way valve. It has stronger mechanical properties than gray cast iron.
- SCPH2 (carbon steel cast steel): Material with excellent wear resistance and wide temperature and pressure ranges.
- SCS13A (Stainless cast steel): Austenitic stainless cast steel product, SCS material equivalent to SUS304
- SCS14A (Stainless cast steel): Austenitic stainless cast steel product, SCS material equivalent to SUS316

※In addition, we also handle special materials such as aluminum bronze and titanium. We will select according to your specifications; please contact us.

Made of cast steel (main body material: SCPH2)

10K/150Lb

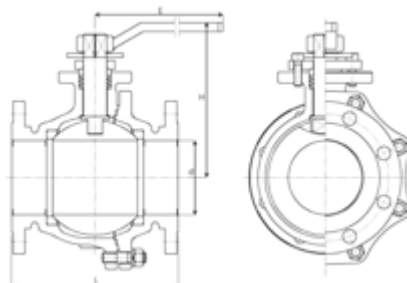

Part name	Standard material
Body	SCPH2
Flange	SCPH2
Ball	SUS304/SCS13A
Stem	SUS304
Ball seat	MR-NBR/PTFE

*For the ball seats, check the details.

Size	15A	20A	25A	32A	40A	50A	65A	80A	100A	125A	150A	200A	250A
d: Diameter	15	19	25	32	38	50	63.5	76	102	127	152	203	254
L: Face-to-face dimension	110	120	130	140	165	178	190	203	229	356	394	457	533
H: Height	89	92	109	114	119	138	157	188	213	236	258	These products are operated by worm gears. Contact us separately.	
E: Lever dimension	140	140	180	180	180	260	260	350	450	450	600		

*For other diameters, contact us separately.

20K/300Lb

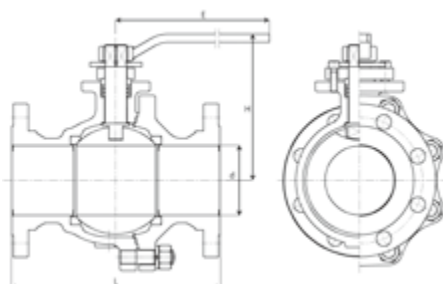

Part name	Standard material
Body	SCPH2
Flange	SCPH2
Ball	SUS304/SCS13A
Stem	SUS304
Ball seat	R.PTFE

*For the ball seats, check the details.

Size	15A	20A	25A	32A	40A	50A	65A	80A	100A	125A	150A	200A	250A
d: Diameter	15	19	25	32	38	50	63.5	76	102	127	152	203	254
L: Face-to-face dimension	140	152	165	178	190	216	241	283	305	381	403	502	568
H: Height	89	99	109	114	119	137	165	188	213	251	287	These products are operated by worm gears. Contact us separately.	
E: Lever dimension	140	140	180	180	190	260	450	450	600	600	800		

*For other diameters, contact us separately.

40K/600Lb

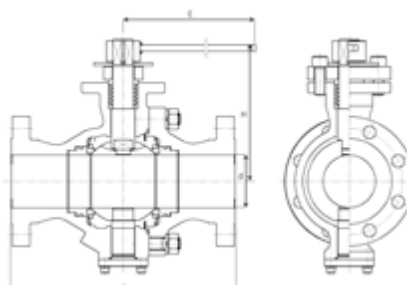

Part name	Standard material
Body	SCPH2
Flange	SCPH2
Ball	SUS304 /SCS13A
Stem	SUS304
Ball seat	R.PTFE

*For the ball seats, check the details.

サイズ	15A	20A	25A	32A	40A	50A	65A	80A	100A	125A	150A
d: Diameter	13	19	25	32	38	51	64	76	102	127	152
L: Face-to-face dimension	165	190	216	241	241	292	330	356	432	508	559
H: Height	95	100	105	130	130	160	195	215	These products are operated by worm gears. Contact us separately.		
E: Lever dimension	180	180	180	300	300	450	600	800			

*For other diameters, contact us separately.

Three-way ball valve

• Three-way switching ball valves and their flow patterns

90° operation is standard for the three-way switching ball valve. The switching position is as follows:

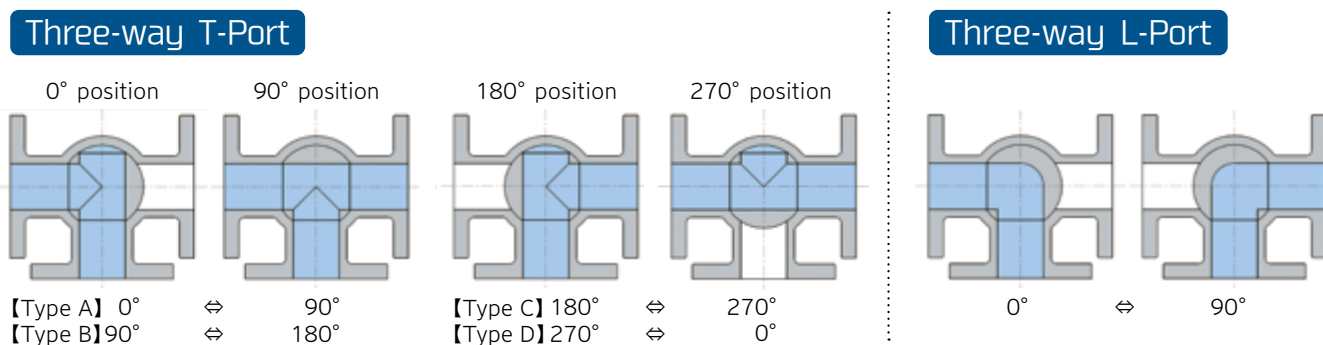

Made of ductile cast iron or stainless cast steel (main body material: FCD450, SCS13A or SCS14A)

FCD450 10K

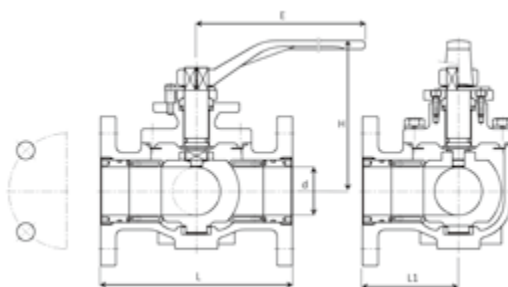
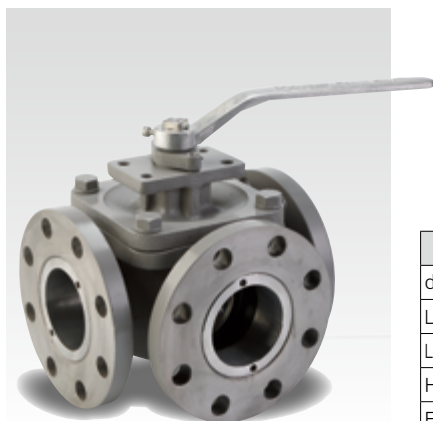

Part name	Standard material
Body	FCD
Hood	FCD
Ball	SUS304/SCS13A
Stem	SUS304
Ball seat	MR-NBR/PTFE

*For the ball seats, check the details.

Size	25A	32A	40A	50A	65A	80A	100A	125A	150A	200A	250A
d: Diameter	25	32	38	50	63.5	76	100	125	150	203	254
L: Face-to-face dimension	165	180	190	200	230	240	290	410	450	700	850
L1: Center-to-face dimension	82.5	90	95	100	115	120	145	205	225	350	425
H: Height	117	145	145	160	166	187	229	260	275	These products are operated by worm gears. Contact us separately.	
E: Lever dimension	180	260	260	260	260	260	350	450	450		

*For other diameters, contact us separately.

SCS13A/SCS14A 10K

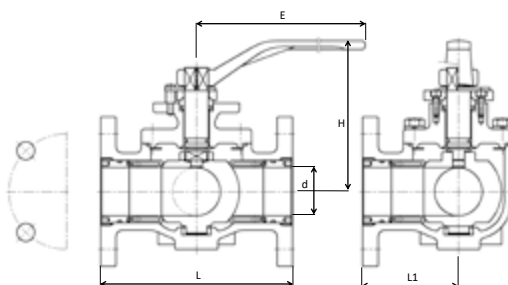

Part name	Standard material	
Body	SCS13A	SCS14A
Hood	SCS13A	SCS14A
Ball	SUS304/SCS13A	SUS316/SCS14A
Stem	SUS304	SUS316
Ball seat	MR-NBR/PTFE	MR-NBR/PTFE

*For the ball seats, check the details.

Size	25A	32A	40A	50A	65A	80A	100A	125A	150A	200A	250A
d: Diameter	25	32	38	50	63.5	76	100	125	150	203	254
L: Face-to-face dimension	165	180	190	200	230	240	290	410	450	700	850
L1: Center-to-face dimension	82.5	90	95	100	115	120	145	205	225	350	425
H: Height	117	145	145	160	166	187	229	260	275	These products are operated by worm gears. Contact us separately.	
E: Lever dimension	180	260	260	260	260	260	350	450	450		

*For other diameters, contact us separately.

Screw-in type 2-way ball valves

Made of ductile cast iron or stainless cast steel (main body material: FCD-S, SCS13A or SCS14A)

FCD-S Rc

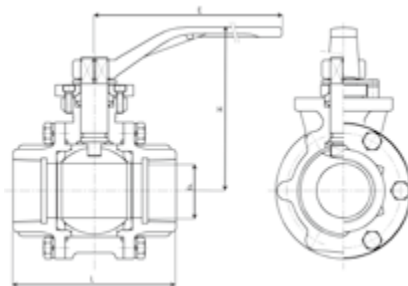

Part name	Standard material
Body	FCD-S
Flange	FCD-S
Ball	SUS304
Stem	SUS304
Ball seat	MR-NBR/PTFE

*For the ball seats, check the details.

Size	15A	20A	25A	32A	40A	50A
d 口径	15	19	25	32	38	50
L: Face-to-face dimension	75	80	95	115	135	150
H: Height	90	104	114	119	124	150
E: Lever dimension	140	180	180	180	180	260
Rc, -S	1/2	3/4	1	1 1/4	1 1/2	2

*For other diameters, contact us separately.

SCS13A/SCS14A Rc

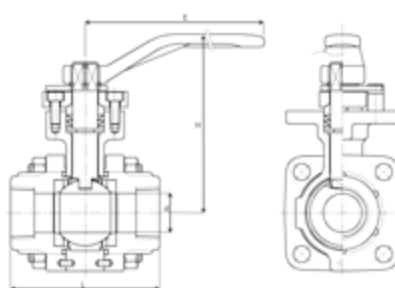

Part name	Standard material	
Body	SCS13A	SCS14A
Flange	SCS13A	SCS14A
Ball	SUS304	SUS316
Stem	SUS304	SUS316
Ball seat	MR-NBR/PTFE	MR-NBR/PTFE

*For the ball seats, check the details.

Size	15A	20A	25A	32A	40A	50A
d 口径	15	19	25	38	38	50
L: Face-to-face dimension	75	80	95	135	135	150
H: Height	90	105	115	124	124	150
E: Lever dimension	140	180	180	180	180	260
Rc, -S	1/2	3/4	1	1 1/4	1 1/2	2

*For other diameters, contact us separately.

YONE After Service

After-purchase services

- The warranty period is 18 months after delivery or 12 months after piping, whichever comes first.
- You can also purchase valve maintenance parts (packings).
- We also accept overhaul requests. (Please contact us for on-site work)

Air cylinder operated high frequency ball valves

Feature of the high frequency ball valve

The air cylinder operated high frequency ball valve is the best valve for piping lines where the valve repeatedly and frequently opens and closes.

This valve is designed and manufactured to have durability for over 100,000 operations.

- **Trunnion method**

This valve adopts the trunnion method for all sizes. By preventing the movement of the ball due to pressure fluctuations, the seat life is extended.

- **Ring adjustment method**

By adopting the ring adjustment method with a built-in disc spring, this valve covers the worn area and prevents internal leakage even if the ball seat wears due to high frequency use.

- **Spline coupling (200A or above)**

In this valve, the mating part of the ball and stem is splined to improve durability.

- **Special liner method**

The stem part uses a special liner method to prevent burning and seizure.

FCD-10K(150Lb)/ 20K(300Lb) -2 way-YHW

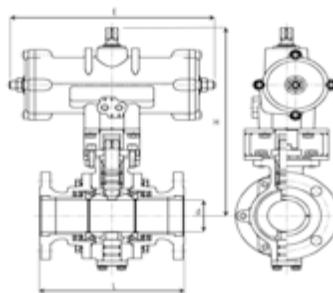
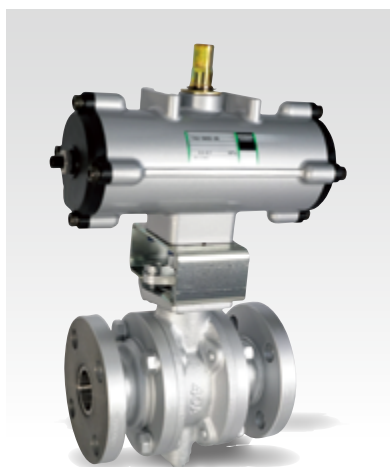

Part name	Standard material
Body	FCD450
Flange	FCD450
Ball	SUS304/SCS13A
Stem	SUS304
Ball seat	R.PTFE

*For the ball seats, check the details.

Size	40A	50A	65A	80A	100A	125A	150A
d: Diameter	38	50	63.5	76	102	127	152
L: Face-to-face dimension	190	216	241	283	305	381	403
H: Height	321	372	377	427	498	528	687
E: Cylinder length	276	342	342	420	506	506	664

*For other diameters, contact us separately.

FCD-10K(150Lb)/ 20K(300Lb) -3 way-YHW

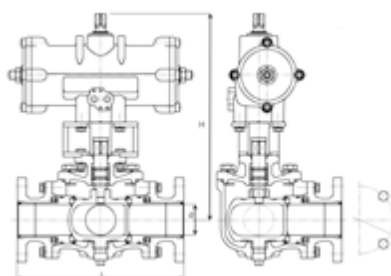

Part name	Standard material
Body	FCD450
Hood	FCD450
Ball	SUS304/SCS13A
Stem	SUS304
Ball seat	R.PTFE

*For the ball seats, check the details.

Size	40A	50A	65A	80A	100A	125A	150A
d: Diameter	38	50	63.5	76	102	127	152
L: Face-to-face dimension	280	300	340	400	450	530	620
L1: Center-to-face dimension	140	150	170	200	225	265	310
H: Height	322	383	394	455	540	560	682
E: Cylinder length	276	342	342	420	506	506	664

*For other diameters, contact us separately.

Air cylinder operated ball valves

The ball valve with the rotary actuator TA2 series is designed to satisfy your needs for compactness, reliability and functionality with automated equipment. The TA2 series demonstrates optimum torque performance by adopting the Scotch yoke drive system. In addition, we are improving the reliability in all aspects such as oil-free packing.

Specify the type number to order options.

All TA2 cylinder options are mounted in a unit fashion. Therefore, no matter which option is installed, it is very compact. Specify the type number below when ordering.



Double acting



Single acting (spring return)

This type is also effective for opening and closing in emergencies.

TYPE-00

With cylinder only

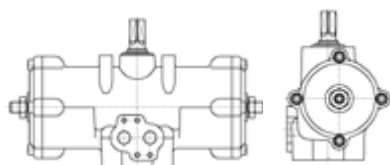

TYPE-01

With solenoid valve

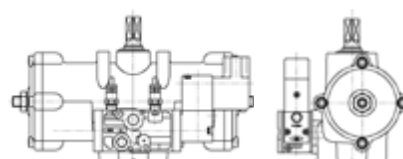

TYPE-02

With solenoid valve and FR unit

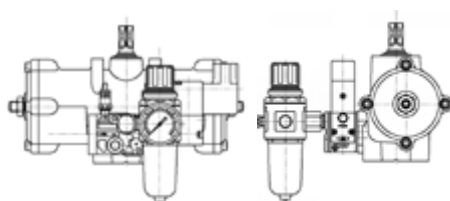

TYPE-03

With solenoid valve and switch box

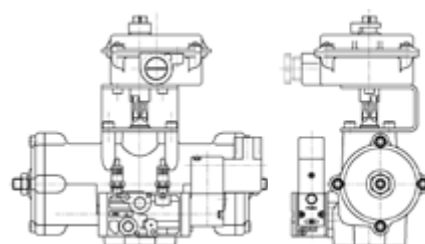

TYPE-04

With solenoid valve, FR unit and switch box

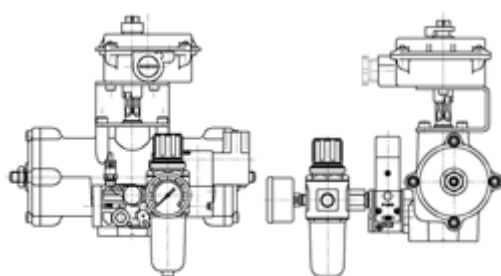

TYPE-05

With switch box only

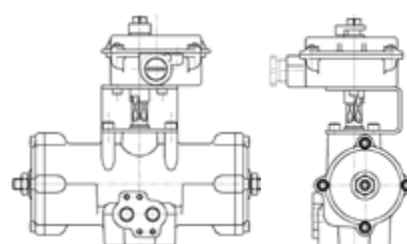

※Each ball valve can be automated. (Excluding RE and SL ball valves)

Electric motor operated ball valves

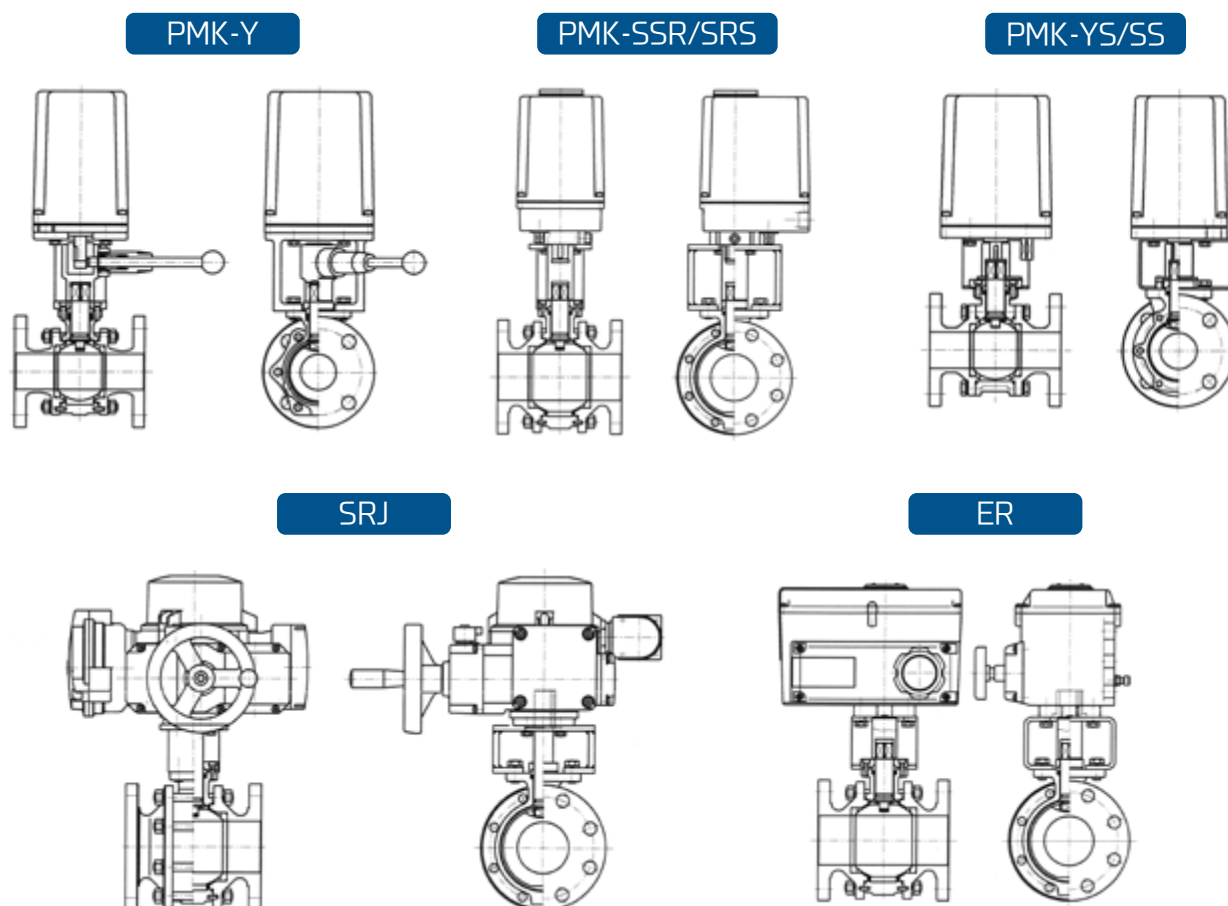

※Each ball valve can be electrified. (Excluding RE and SL ball valves)

■ Specification of the motor operation machines

No.	Model	Applicable diameter	Operation	Manual	Single phase	Three-phase	DC	IP code	Explosion protection	Feature
1	PMK-Y (MVY)	15A~65A	ON-OFF (rotate 90 degrees)	○	○	*	*	Equivalent to IP54	×	Lightweight and compact. With pin clutch manual handle.
2	PMK-SSR/SRS	15A~150A	ON-OFF (rotate 90 degrees)	×	○	*	*	Equivalent to IP54	×	Spring return. Used for emergency shutoff valves.
3	PMK-YS/SS	15A~150A	ON-OFF (rotate 90 degrees)	○	○	*	*	Equivalent to IP54	×	Lightweight and compact, offers excellent cost performance.
4	SRJ	15A~300A	ON-OFF (rotate 90 degrees)	○	○	○	×	IP68	OP	Suitable for outdoor use and can be used with a wide range of diameters and AC power supplies.
5	ER	15A~150A	ON-OFF (rotate 90 degrees)	○	○	○	×	IP66	×	Suitable for outdoor use and can be used with a wide range of AC power supplies.

*.....For this item, please contact us.

OP.....Option

※The compatible diameter conforms to JIS10K as the standard.

Other Products

Fire fighting equipment

RC Monitor EM-3MR EM-3MR

A remote-controlled electric water monitor with a lightweight and compact design. Despite its small size, it can discharge 0.7Mpa (3,000 liters/min).



RC Monitor EM-21/2GSH EM-21/2GSH

A remote-controlled electric water monitor with excellent design. This model is designed to withstand high-frequency use and is often used in sprinklers. A maximum of 1,900 liters/min of water can be discharged.



PROEYE search and rescue cameras

At disaster sites such as building collapses and landslides caused by earthquakes and typhoons, prompt search and rescue are required. Since our PROEYE series launched in 1993, it has been highly evaluated as a search and rescue camera with excellent waterproofness and operability. Many RESCUES workers in Japan and overseas have adopted our PROEYE series.



Couplings (YC couplings)

Completely removable with one-touch!

YONE YC couplings are used to transport all fluids. An epoch-making hose coupling that can be combined with a complete one-touch operation.





YONE CORPORATION

HEAD OFFICE :

23, NISHINAKAI-CHO, NISHINOKYO, NAKAGYO-KU, KYOTO 604-8441 JAPAN

TEL : KYOTO 075(821)1185 FAX 075(801)2263

TOKYO BRANCH :

1-14-7 KIKUKAWA, SUMIDA-KU, TOKYO 130-0024 JAPAN

TEL : TOKYO 03(3634)6611 FAX 03(3632)0246

<https://www.yone-co.co.jp/>



YONE



※The information contained in this catalog may be revised without notice due to changes in specifications and design or discontinuation of production. Check the latest information in advance when ordering.

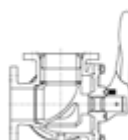
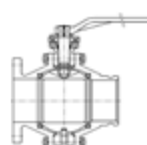
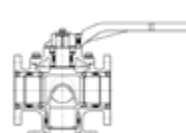
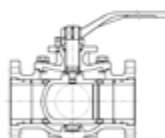
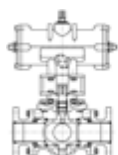
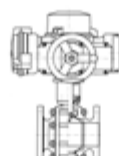
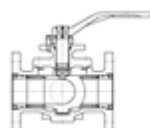
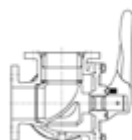
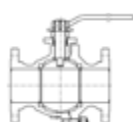
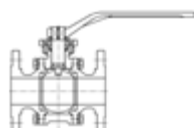
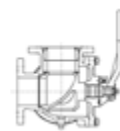
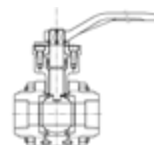
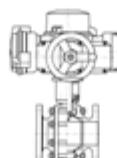
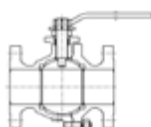
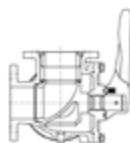
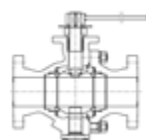
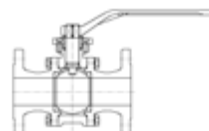
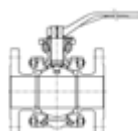
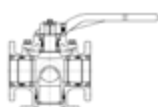
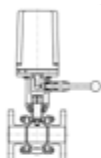
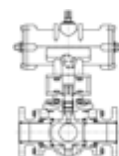
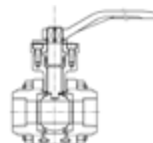
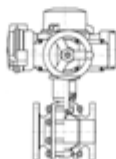
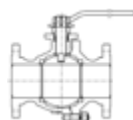
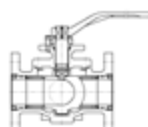
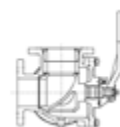
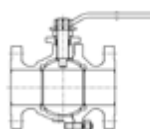
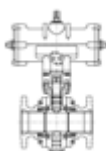
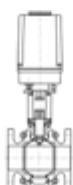
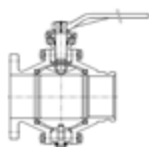
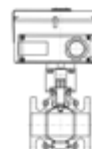
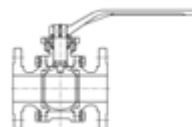
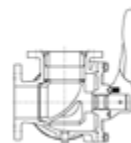
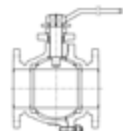
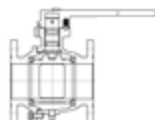

YONE Valve Code

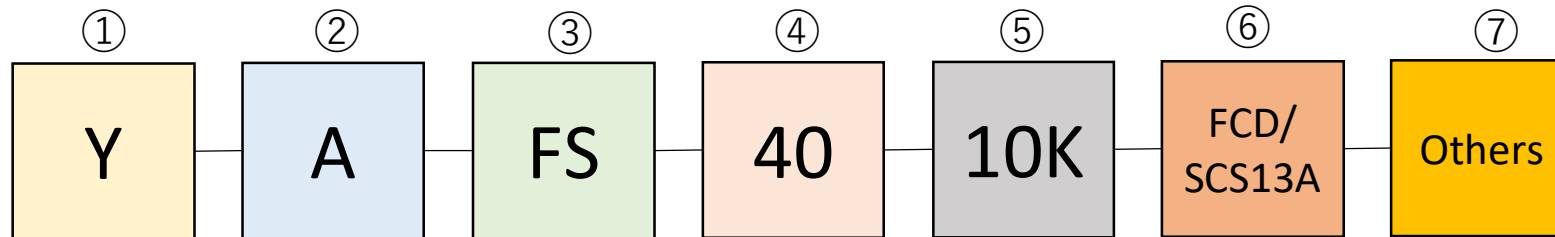

①Model	
Y	PTFE Rever type
MR	MR Rever type
YHW	High Frequency type
MVY	(PTFE)Small Electric Motor
MVM	(MR)Small Electric Motor

⑤Pressure Rating	
5K	JIS5K
10K	JIS10K
16K	JIS16K
20K	JIS20K
30K	JIS30K
40K	JIS40K
125	ANSI Class 125
150	ANSI Class 150
300	ANSI Class 300
600	ANSI Class 600

②Operate	
L	Rever type
G	Worm Gears type
A	Double Acting Air Cylinder
AS	Single Acting Air Cylinder
E	Double Acting Electric Moter
ES	Single Acting Electric Moter
AP	High Frequency Air Cylinder

⑥Body/Ball	
FC200/SCS13A	
FCD/SCS13A	
SCPH2/SCS13A	
SCS13A/SCS13A	
SCS14A/SCS14A	
ALBC3/MONEL	

③Connection+Bore	
F	Flange type
SE	Screw type
SW	Socket Weld
BW	Butt Weld
+	
S	Full Bore
V	Reduced Bore
+	
F3T	Three-way T-port
F3L	Three-way L-port

⑦Detailed Instructions	
------------------------	--

④Size	
10A (3/8)	
15A(1/2)	
20A(3/4)	
25A(1)	
32A(1-1/4)	
40A(1-1/2)	
50A(2)	
65A(2-1/2)	
80A(3)	
100A(4)	
125A(5)	
150A(6)	
200A(8)	
250A(10)	
300A(14)	
400A(16)	
450A(18)	
500A(20)	